

The next Generation

The new Rotary Limit Switch Series FRM heralds the next Generation of Rotary Limit Switches. With this new Rotary Limit Switch complete new and much more complex monitoring-, control- and switch-functions can be carried out.

The rotary limit switch is a device which allows you to control the movement of industrial and building machines. The shaft is connected to the motor, so that, after a certain number of turns, the cams make the switches work, and then they can carry out their pre-set manoeuvre.

The innovative and thorough regulation of the cams allows you to set the microswitches working point linearly and micrometrically.

The choice of different cam profiles allows you to modify the limit switches function diagram.

For the Rotary Limit Switch Series FRM revolution ratios from 1:1 up to 1:900 are available. The Rotary Limit Switch can be equipped with maximum 8 switches. Each cam can be adjusted separately on its position in order to define reference or end positions.

To minimize abrasion and rust the transmission and guide shafts of the gear wheels are manufactured of stainless steel.

All materials which are in direct contact with the environment are resistant to gases, oils and extreme temperature changes. The rubber sealing allows a maximum protection against water and dust, which leads to the protection degree of IP66. The optimized inner space of the rotary limit switch allows a easy cabling.

Technische Characteristics

Marking	: CE
harm. Rules	: EN60947-1, EN60947-5-1, EN60529, EN60204-1, EN60529, EN418, 2006/95 CE, 98/37 CE
Rated Voltage	: 250V ~
Max. Operating Voltage	: 250V ~
Temperature Operational	: -40°C - +60°C
Insulation Class	: Class II
Protection Degree	: IP 66
Cable Entry	: M20x1,5 cable gland
Material Enclosure	: Thermoplastics
Material Shaft	: Stainless Steel
Shaft Diameter	: 12mm
Weight	: ca. 500g

Dimensions

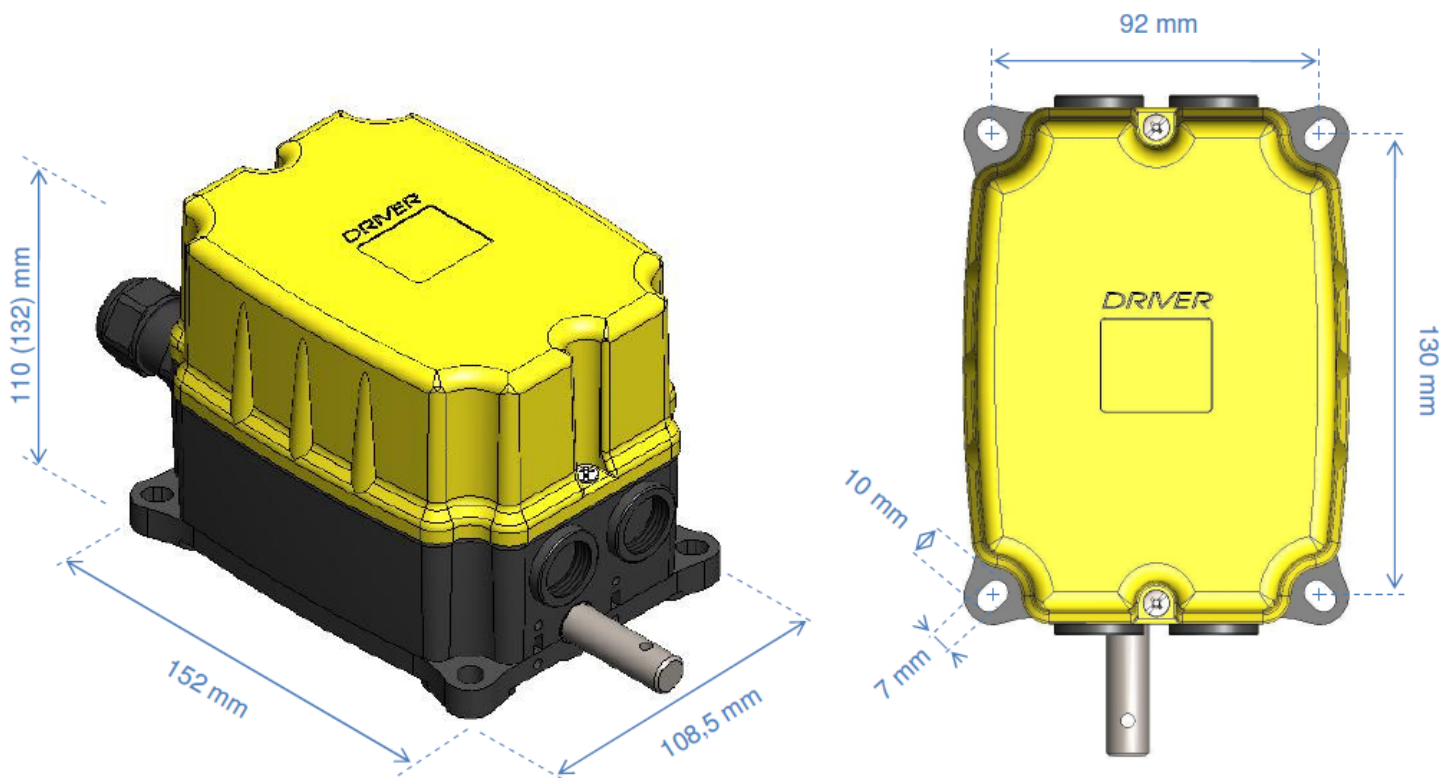

Mounting Dimensions

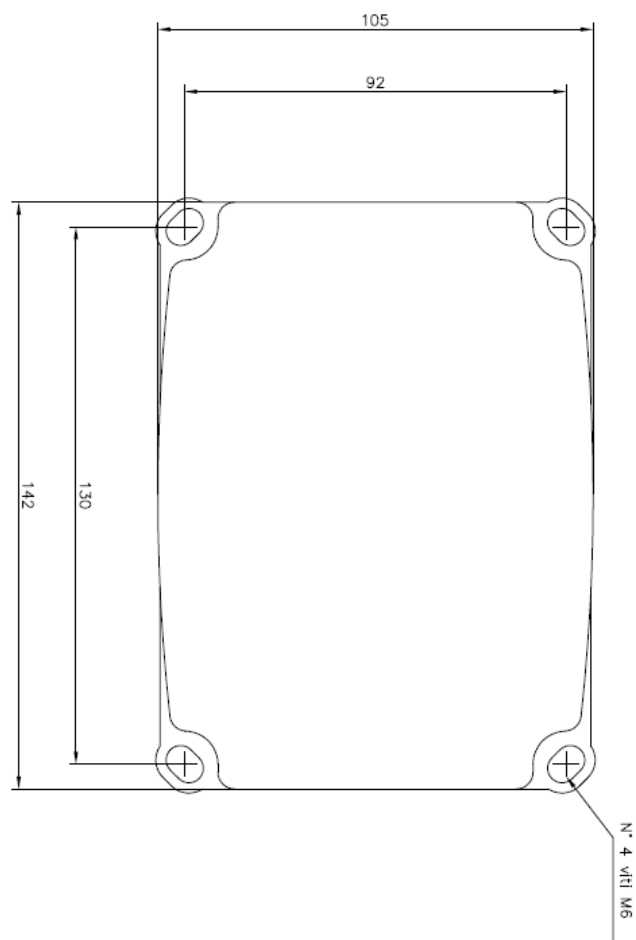

Technical Characteristics Contact Elements

Switches: Snap Action (1NO/1NC Changeover Contact)
 Harm. Rules: EN90947-5-1
 Insulation Voltage: 250 V~
 Operational Current: 10(3)A
 Mechanical Lifetime: 2 Million operations

Performance

AC15	$V_e(V)$	24	48	110	230
	$I_e(A)$	10	10	6	3
DC13	$V_e(V)$	24	48	110	230
	$I_e(A)$	3	1,5	0,8	0,4

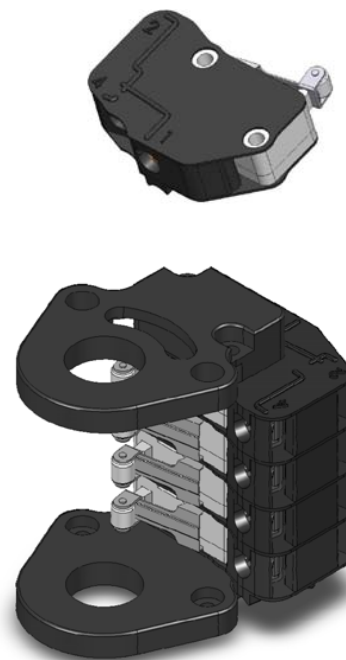
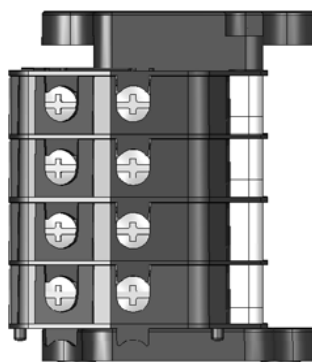

Options Cams



20 °



45 °



90 °



180 °



270 °



10-point cam

Mountings for Potentiometer / Encoder

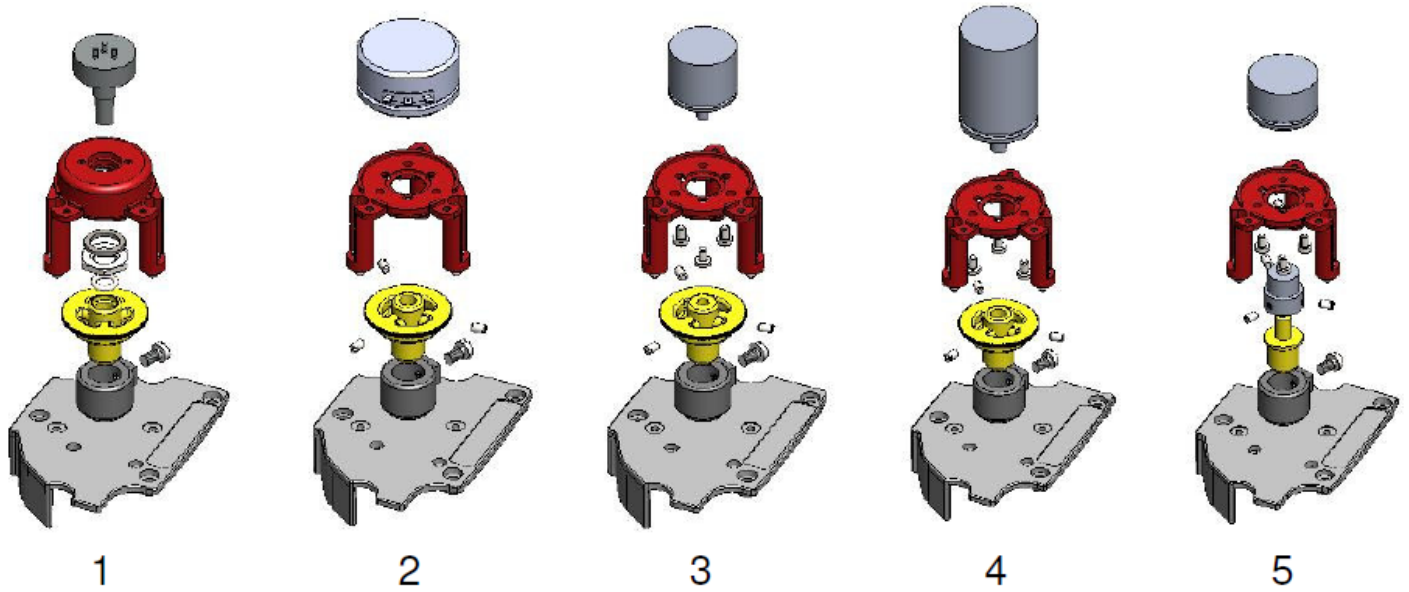

Options Gear Outtakes

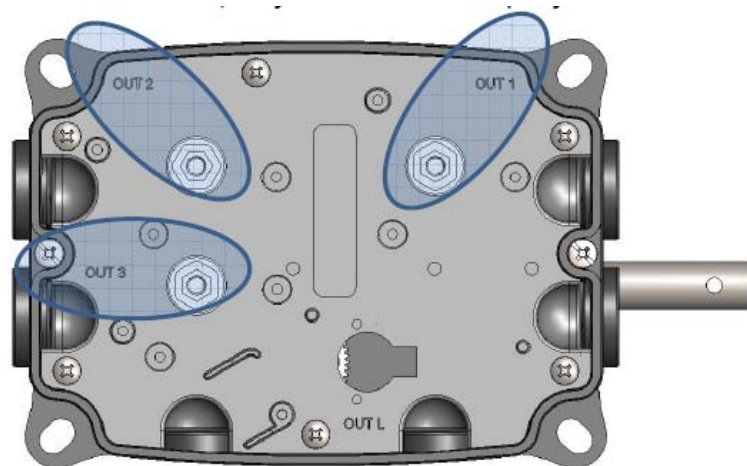

	OUT 1	OUT 2	OUT 3
A	 Different available ratios (1:N)	 Different available ratios (1:N or 1:K)	Not usable
B	 Different available ratios (1:N)	Not usable	 Only available 1:1 ratio

Rotary Limit Switch including Potentiometer and Speed Reader

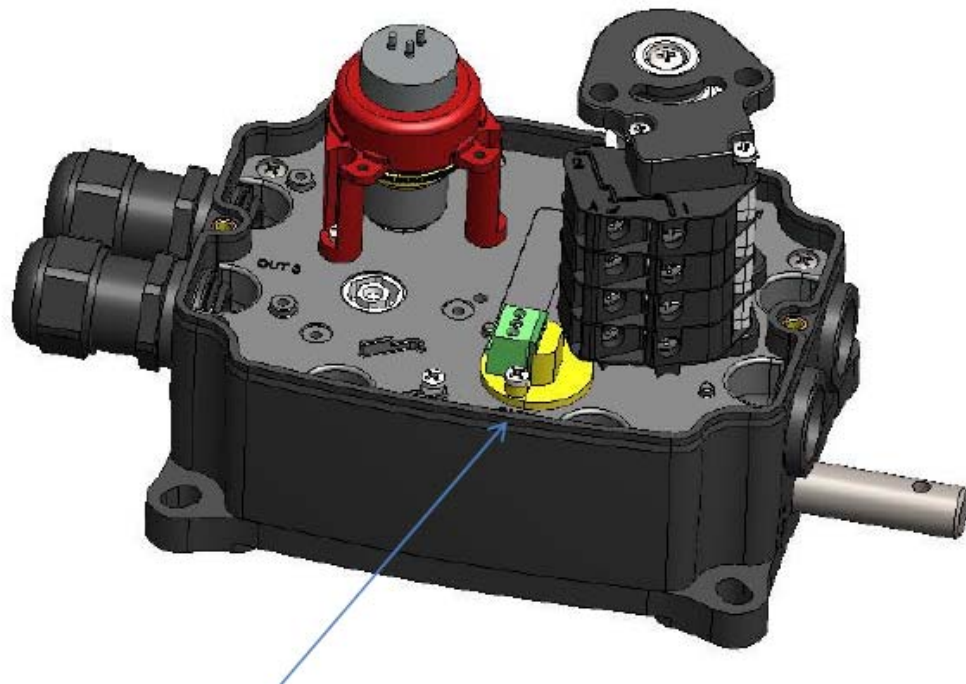

Rotary Limit Switch including Switchboard and Encoder

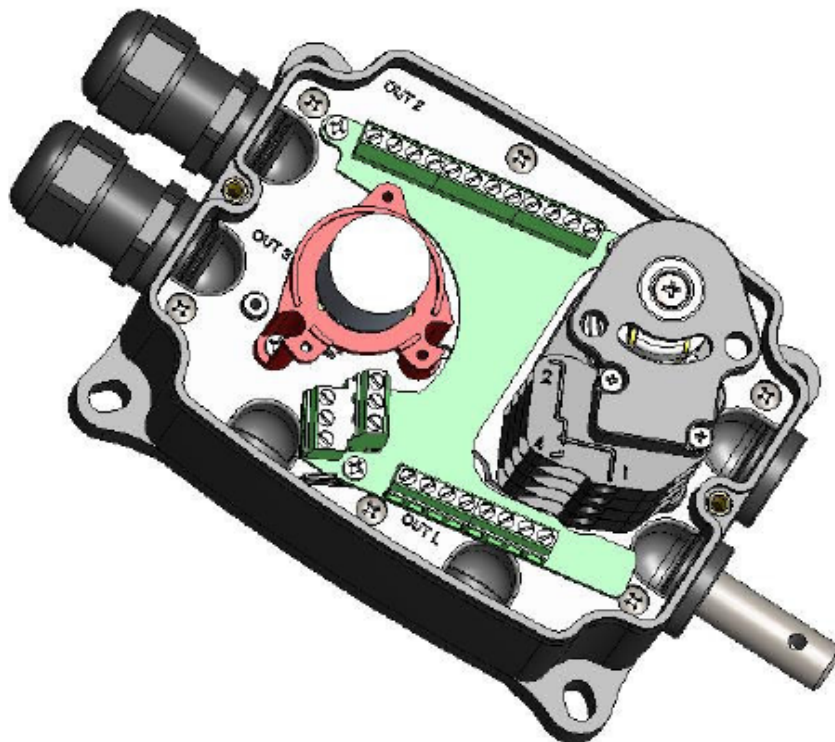

B-COMMAND GmbH

Gruetzmuehlenweg 46 - 22339 Hamburg

Tel: +49 40-538092-50 - Fax: +49 40-538092-85

www.b-command.com - Mail: info@b-command.com